



FACE ACCESS CONTROL

K5 / K5F

Voice navigation version

Manual



FACE ACCESS CONTROL K5/ K5F

Model:	K5/K5F
Dimensions:	W79mm x H145mm x T19mm
Material quality:	Aluminum frame
Communication :	Bluetooth 5.0
Support systems:	Android 4.3/IOS7.0 above
Quiescent current:	≈ 15mA
Dynamic current:	≈ 1A
Power supply mode:	12V
Unlocking time:	≈ 1.5S
Waterproof grade:	IP66
Face capacity:	100
Card capacity:	1000
Fingerprint capacity: (optional)	100(K5F only)

Packaging accessories



Access control host x1

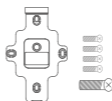

Mounting plate x 1
Screw: 4+1



Manual x1



Hex screwdriver x1

Installation steps

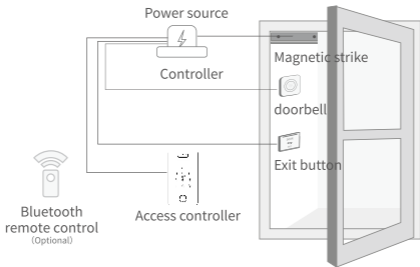

- 1 Drill a hole for the cable
- 2 Install the mounting plate

At the appropriate location, connect the access control cable to the power supply slot.

Remove the fixed bracket from the access control, and then fix it with self tapping screws at the access control slot position. wall with 4 screws.

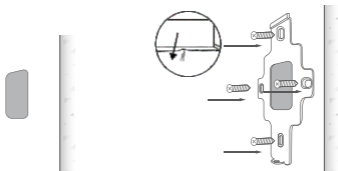



3 Wiring

cut off the connector of the cable, strip and connect the leads to appropriate ports the power supply according to the illustration.

● 1 RED:	12V ⊕
● 2 BLACK:	GND ⊖
● 3 YELLOW:	NC
● 4 WHITE:	COM
● 5 GREEN:	NO
● 6 BLUE:	SW
● 7 ORANGE:	BELL1
● 8 GREY:	BELL2

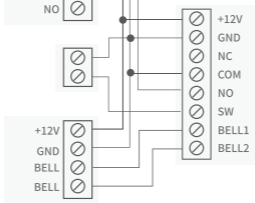
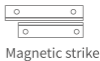
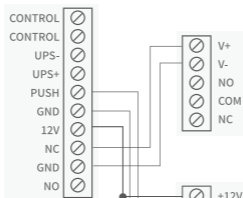



4 Install the buckle

Fit the access controller into the hook and fix it on the mounting plate with a screw in the bottom.





Pair the access controller with app Applicable to TT-LOCK

- 1 Tap the panel to light it up and activate the lock.

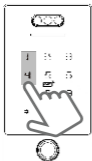

- 2 On voice prompt "Please add Bluetooth Administrator" , activate the APP.



Search in the mobile app store Download and install "TT-LOCK"
Or scan the QR code to download directly

- 3 Tap the "☰" icon on the upper left corner, tap "+Add Lock" , select "Door Lock" .

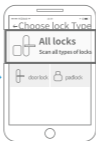

- 4 Tap the device shown on the screen. Wait a few seconds till the lock gives a voice prompt/long beep, which means it is added successfully.



⚠ Note: If the lock cannot be successfully added through the above steps, please close the mobile app, close the mobile Bluetooth, and then reopen the app and Bluetooth, repeating the above steps. but there may still be errors. We do not assume any consequences arising from this.



Product warranty instructions

1. For any defect in material and workmanship, the original purchaser of the product
 - 1) Can return or ask for a replacement within 7 invoice days.
 - 2) Can ask for a replacement within 15 invoice days.
 - 3) Can ask for free repair in 365 invoice days.
2. This warranty does not cover defects caused by modification, alteration, misuse or physical abuse of the product.

Disclaimer:

Our company reserves the right to change the design due to product improvement without prior notice.
All information has been carefully checked to ensure accuracy, but there may still be errors.
We do not assume any consequences arising from this.